

visionaryTM
DESIGNS

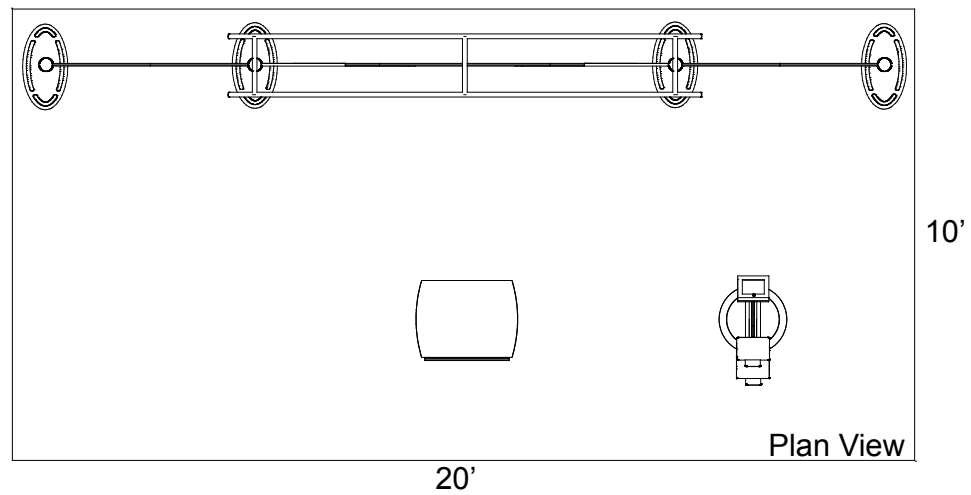
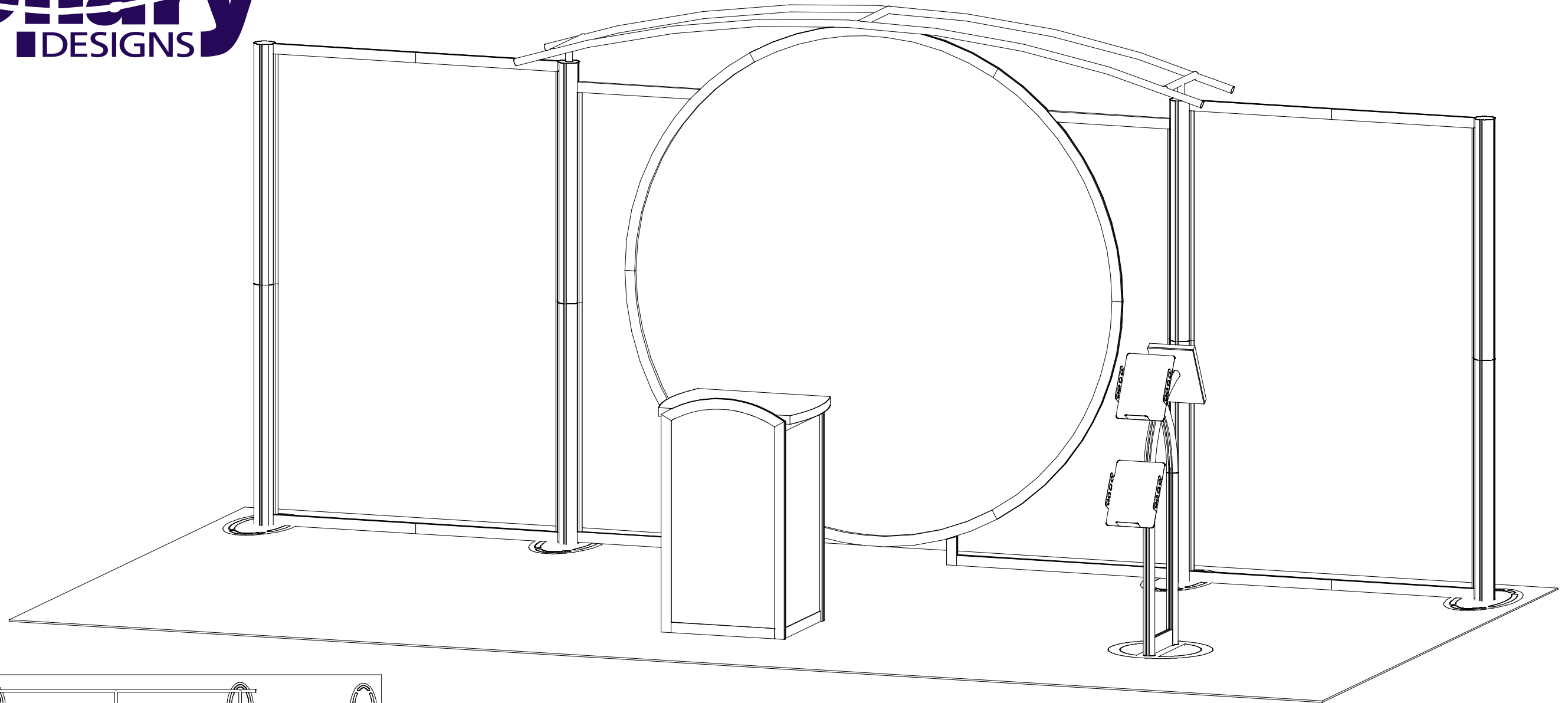

WHEN DISASSEMBLING ALUMINUM EXTRUSION, TIGHTEN ALL SETSCREWS AND LOCKS TO PREVENT LOSS DURING SHIPPING

visionary™ IDESIGNS

Using Your Setup Instructions

The Visionary Designs Setup Instructions are created specifically for your configuration. They are laid out sequentially, including an exploded view of the entire display, and then a logical series of detailed steps to assemble the main structure and components. We encourage you to study the instructions **before** attempting to assemble your exhibit.

Each page reminds you to tighten the setscrews after disassembling your exhibit to prevent loss of the locks and setscrews (see below in RED). This is **VERY IMPORTANT**.

Cleaning and Packing Your Display

- 1) Use care when cleaning aluminum extrusion or acrylic inserts. Use only non-abrasive cleaners.
- 2) When cleaning laminate inserts or countertops, use mild cleansers and a soft material such as cotton.
- 3) Keep all display components away from extreme heat and long exposure to sunlight to avoid warping and fading.
- 4) Retain all packing material. It will make re-packing much easier and will reduce the likelihood of shipping damage.



The Tool

Most Visionary Designs exhibits can be assembled with the supplied Hex Key Tool. Occasionally, a flat head screwdriver may be required.



Typical Connection



Typical Connection (cont'd)

Most horizontal extrusion connections have a patented expandable lock. This lock inserts into the groove of an opposing extrusion. Tightening the lock with the Hex Key Tool expands the lock and creates a strong positive connection.

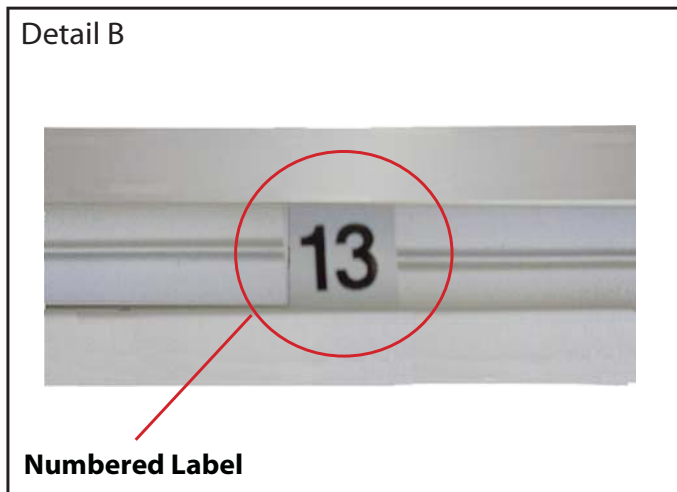

Numbered Label

Each extrusion contains a numbered label which corresponds with setup instructions. The label is located within a groove of the extrusion (when possible). With Visionary Designs the labels contain Black numbers unless otherwise specified.



Horizontal Inline Connection (remove only one setscrew)

Remove only (1) setscrew when disassembling. Replace setscrew in extrusion after assembling it. Before packing, replace setscrew in extrusion to avoid losing it.

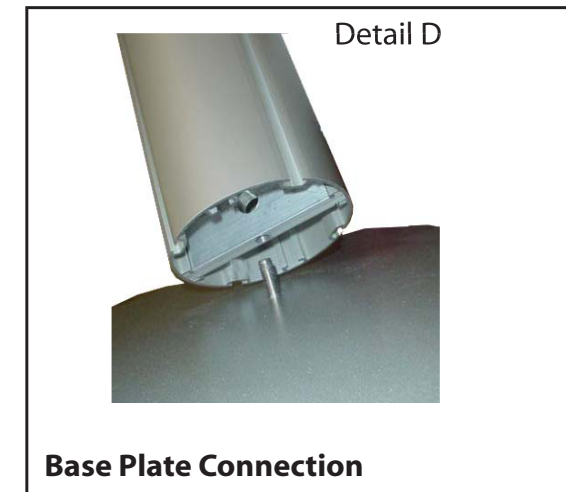

Base Plate Connection

Attach base plate to round or square vertical extrusion using the bolt provided. Be careful not to strip the threads.

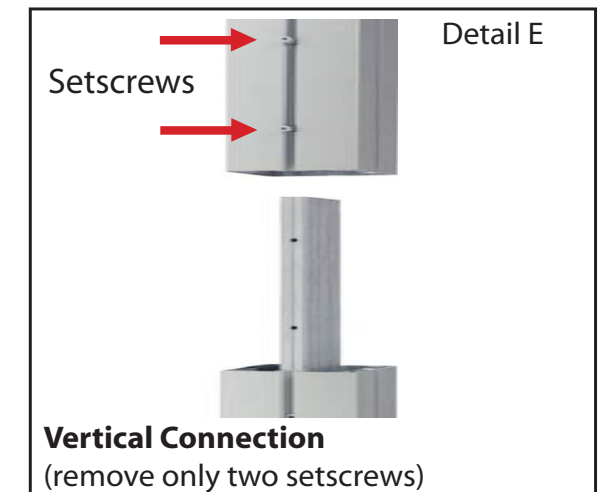

Vertical Connection
(remove only two setscrews)

When vertical extrusions are packed in portable cases rather than crates or tubs, they must be broken down into smaller sections which then require assembly.

Remove only (2) setscrews when disassembling. Replace setscrews in extrusion after assembling it. Before packing, replace setscrews in extrusion to avoid losing them.

WHEN DISASSEMBLING ALUMINUM EXTRUSION, TIGHTEN ALL SETSCREWS AND LOCKS TO PREVENT LOSS DURING SHIPPING

Item	Qty	Description
1	4	Base Plate
2/2a	1/1	42" RR91 Vertical Extrusion
3/3a	1/1	42" RR91 Vertical Extrusion
4/4a	1/1	42" RR91 Vertical Extrusion
5/5a	1/1	42" RR91 Vertical Extrusion
6a/6b	2/2	26" Z45 Horizontal Extrusion
7a/7b	2/2	76" Z45 Horizontal Extrusion
8a/8b	1/1	39" Z45 Horizontal Extrusion
9a/9b	1/1	22.39" Z45 Horizontal Extrusion

Steps:

- 1) Attach lower verticals [2,3,4,5] to base plates [1].
- 2) Attach upper verticals [2a,3a,4a,5a] to lower verticals [2,3,4,5].
- 3) Connect horizontals [6a,6b] and [7a,7b] together.
- 4) Attach horizontals [6a/6b,7a/7b] between verticals [2/2a,3/3a] and [4/4a,5/5a] as shown.
- 5) Attach horizontals [8a & 9a] to verticals [3 & 3a] and horizontals [8b & 9b] to vertical [4 & 4a] as shown.
- 7) Apply graphics to **Velcro** on back of assembled backwall.

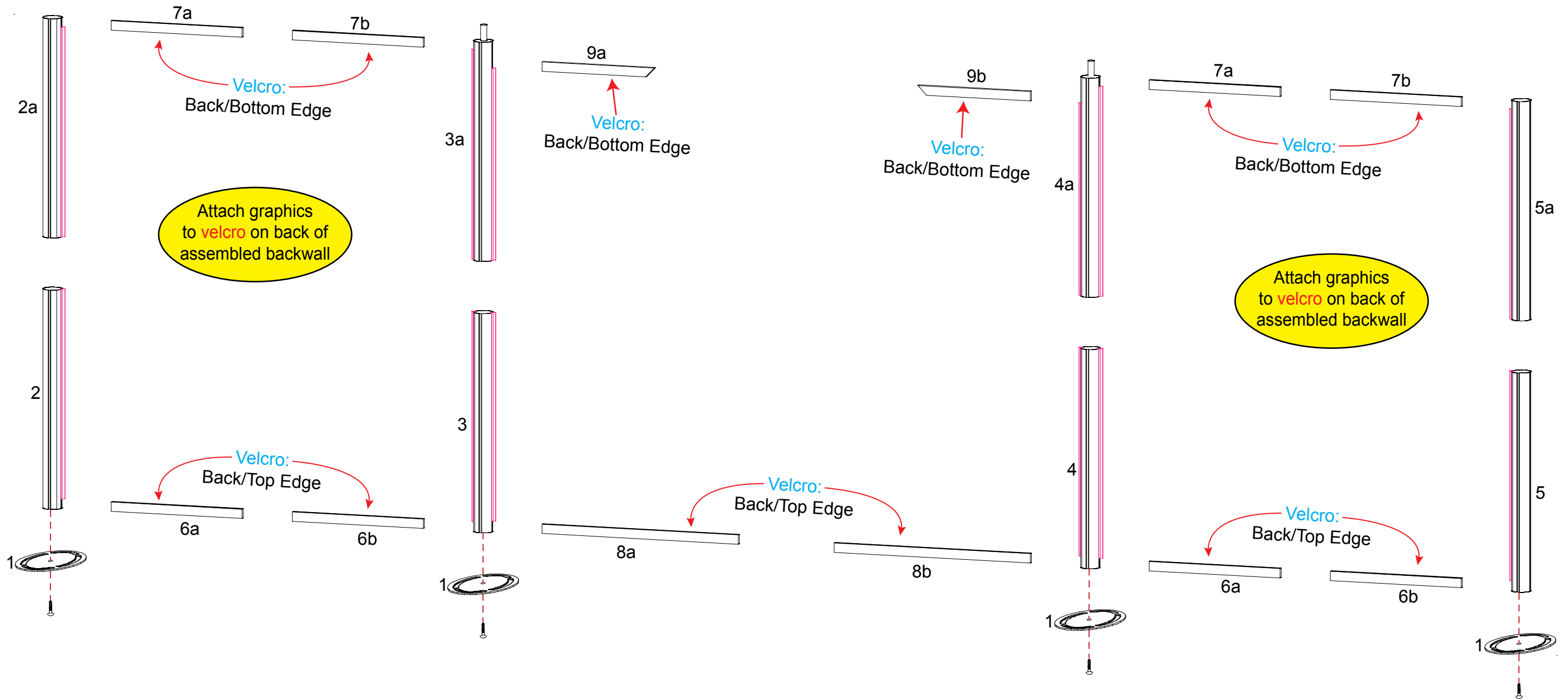
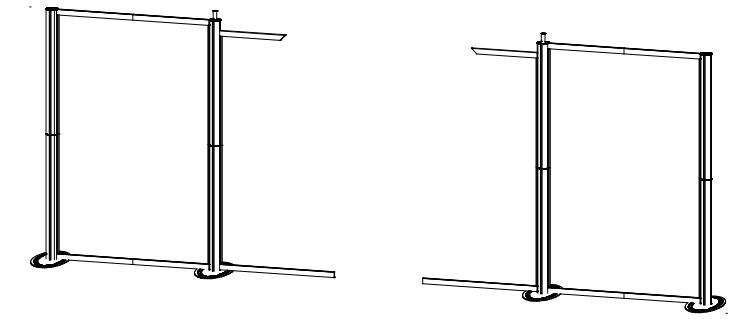

WHEN DISASSEMBLING ALUMINUM EXTRUSION, TIGHTEN ALL SETSCREWS AND LOCKS TO PREVENT LOSS DURING SHIPPING

866.652.2100

Item	Qty	Description
10a/10b	1/1	5.06" Z45 Vertical Extrusion
11	1	47.56" Z45 Curved Extrusion
12	1	47.56" Z45 Curved Extrusion
13	1	47.56" Z45 Curved Extrusion
14	1	47.56" Z45 Curved Extrusion
15	1	47.56" Z45 Curved Extrusion
16	1	47.56" Z45 Curved Extrusion

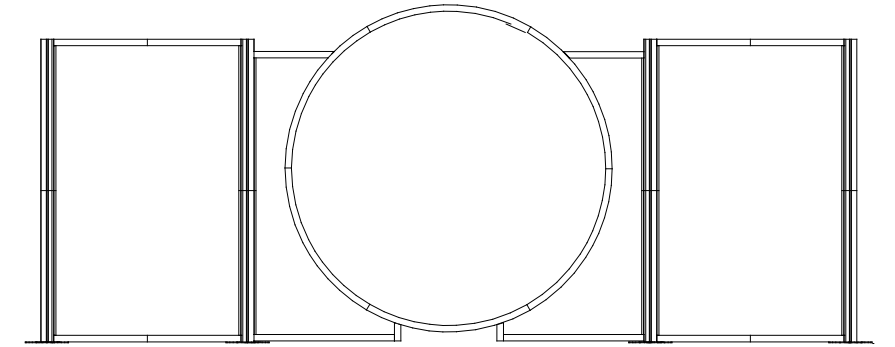
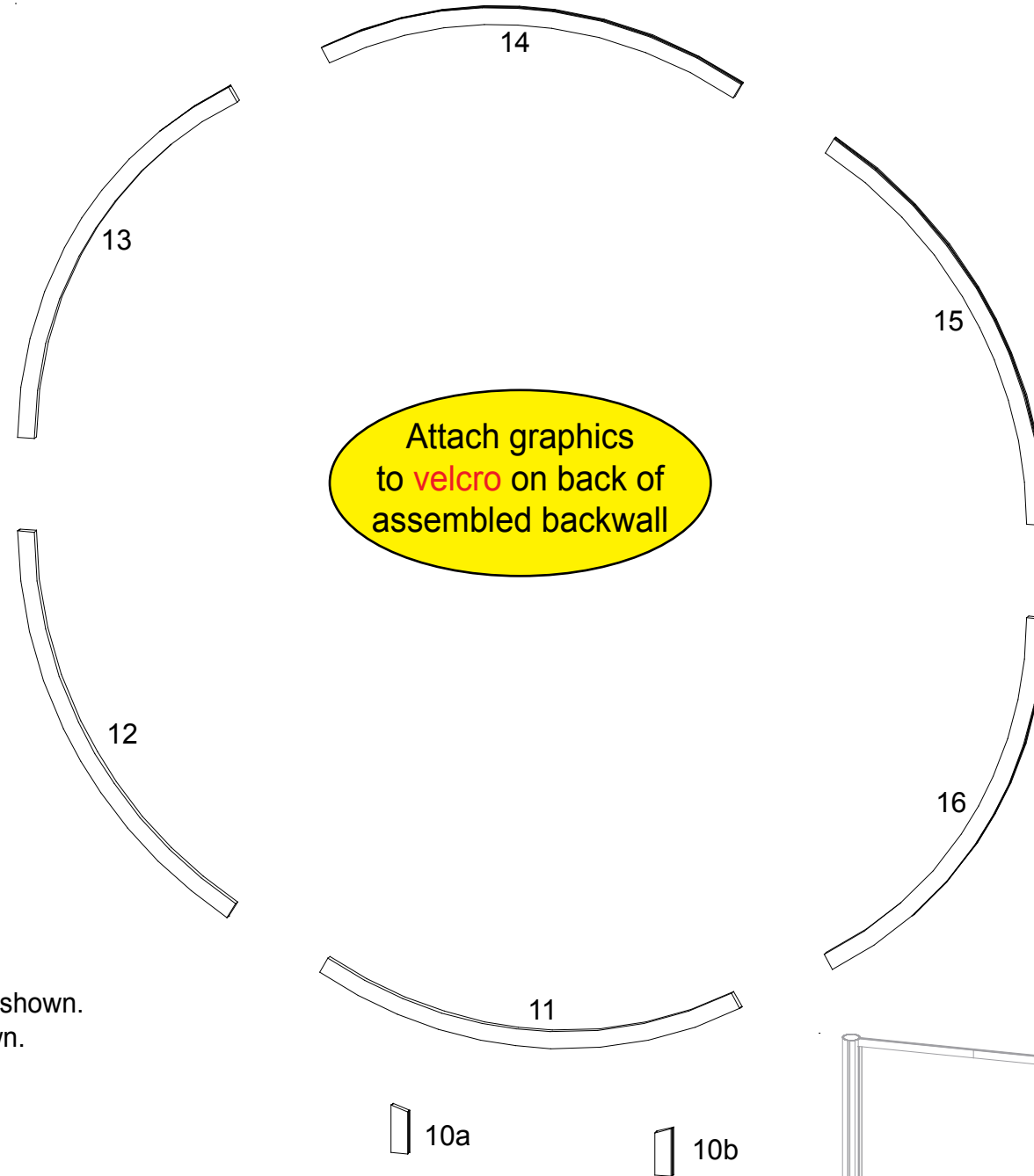

Steps:

- 1) Connect curved extrusions together as shown.
- 2) Attach verticals [10a,10b] to bottom of extrusion [11] as shown.
- 3) Attach verticals [10a,10b] to horizontals [8a,8b] as shown.
- 4) Connect horizontal [9a] to curved extrusion [13] and horizontal [9b] to curved extrusion [15] as shown.
- 5) Attach graphics to backside of assembled frame.

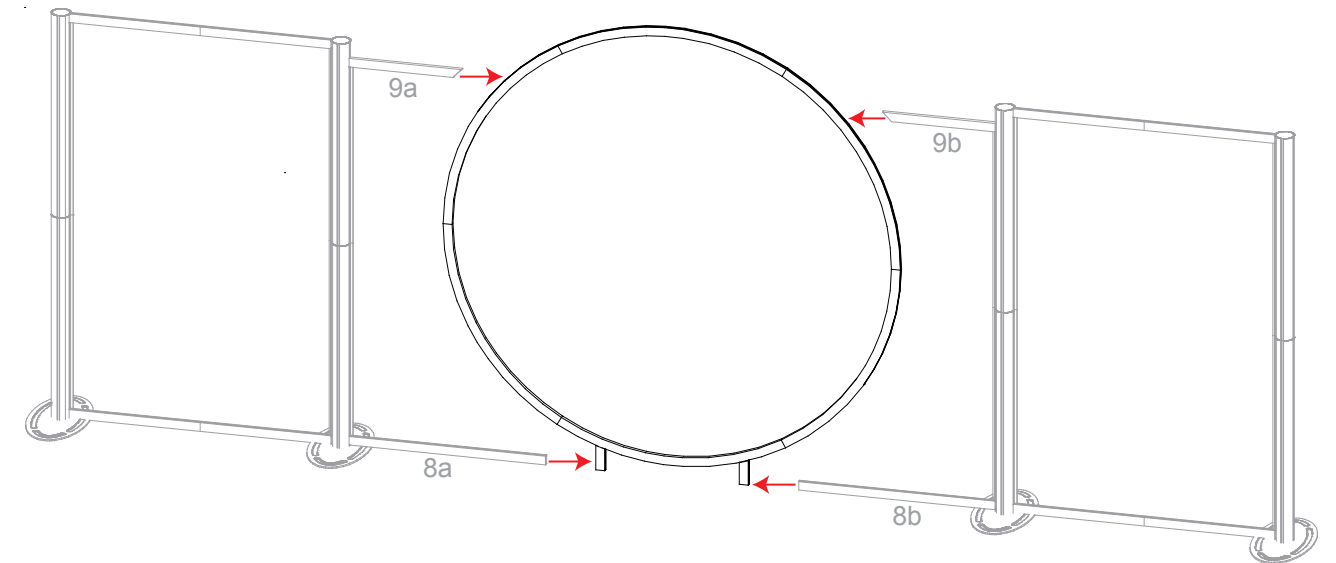

WHEN DISASSEMBLING ALUMINUM EXTRUSION, TIGHTEN ALL SETSCREWS AND LOCKS TO PREVENT LOSS DURING SHIPPING



Using Your Setup Instructions

The Aero Canopy Setup Instructions are created specifically for your configuration. They include an exploded view of the frame which is sequentially numbered. We encourage you to study the instructions before attempting to assemble your exhibit.

Connections are kept very simple: no tools. Everything assembles with push-button connectors and pre-connected horizontal sections.

Cleaning and Packing Your Display

- 1) Use care when cleaning aluminum extrusion or acrylic inserts. Use only non-abrasive cleaners.
- 2) Retain all packing material. It will make re-packing much easier and will reduce the likelihood of shipping damage.

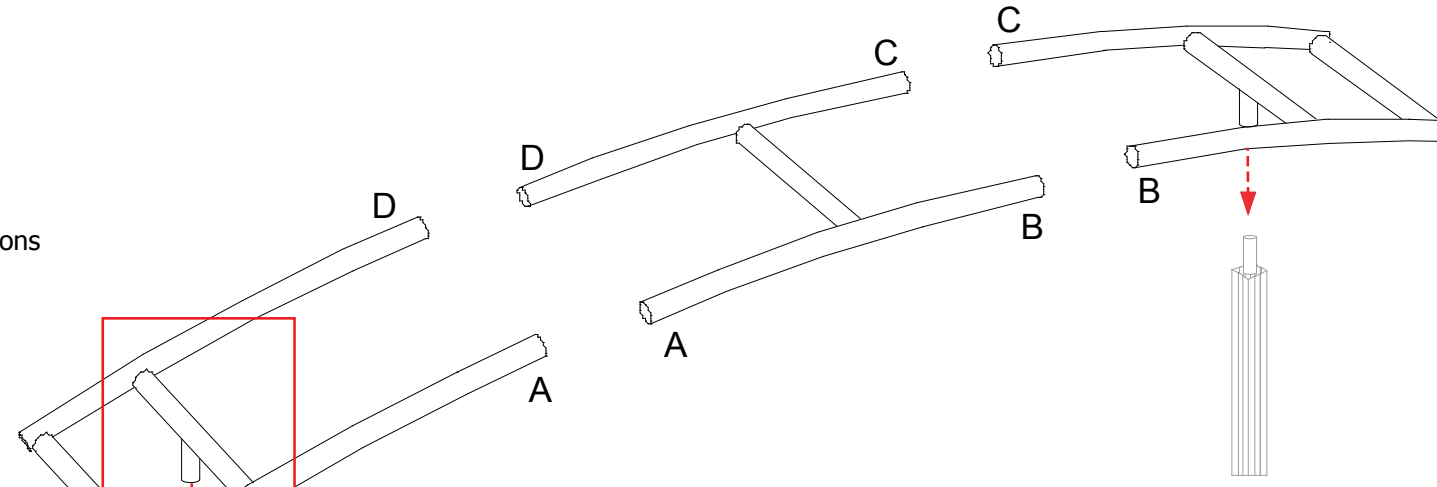

Steps:

- 1) Connect canopy pieces together as shown.
- 2) Apply pillow case graphic to assembled canopy

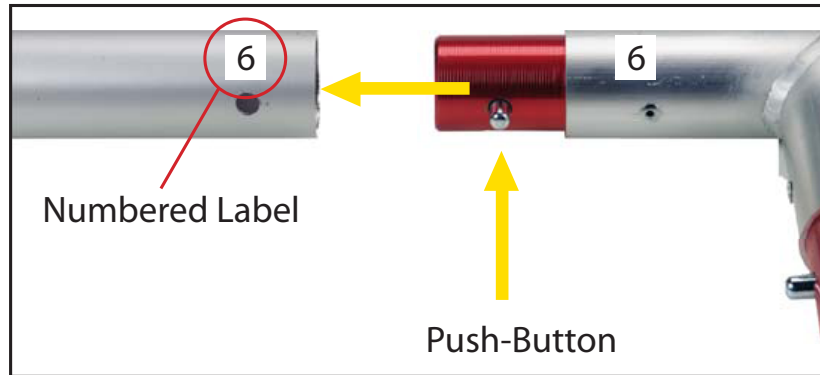

Connections are made by holding the button down and sliding the red tube into opposing tube until the connection is made. To disassemble push button and pull or twist extrusions apart.

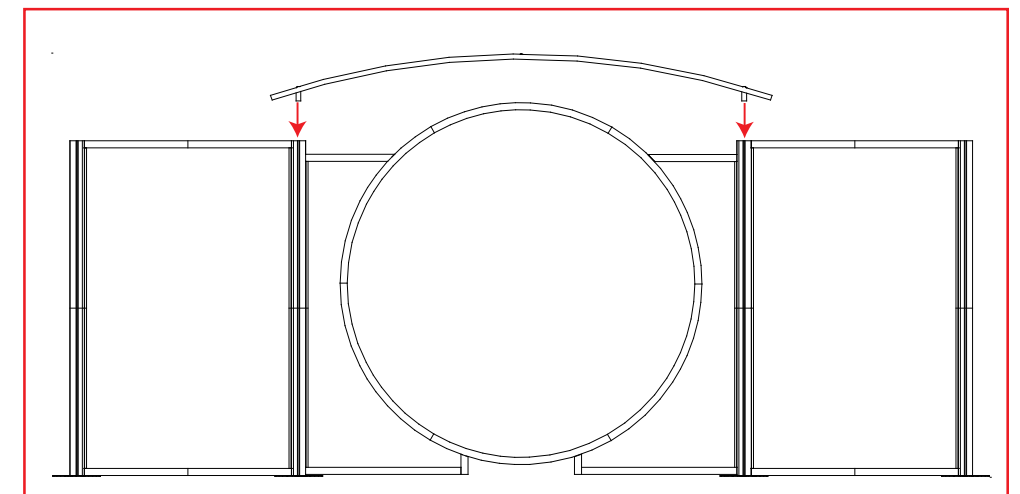
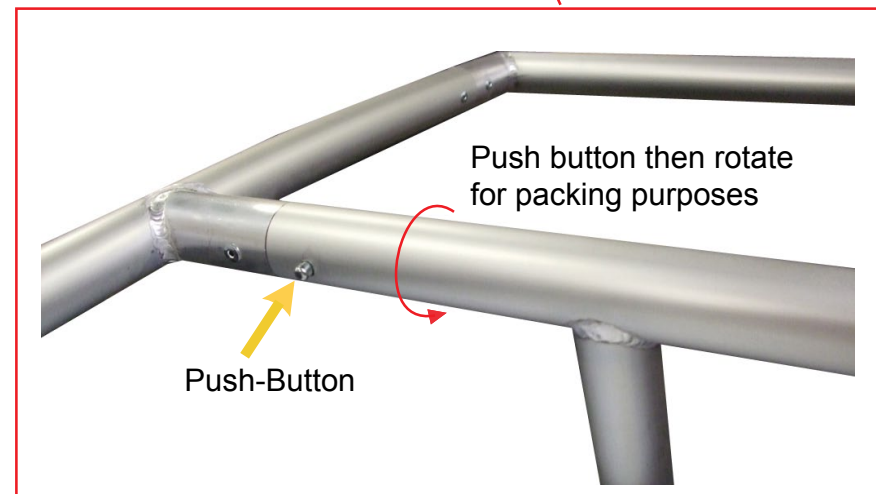
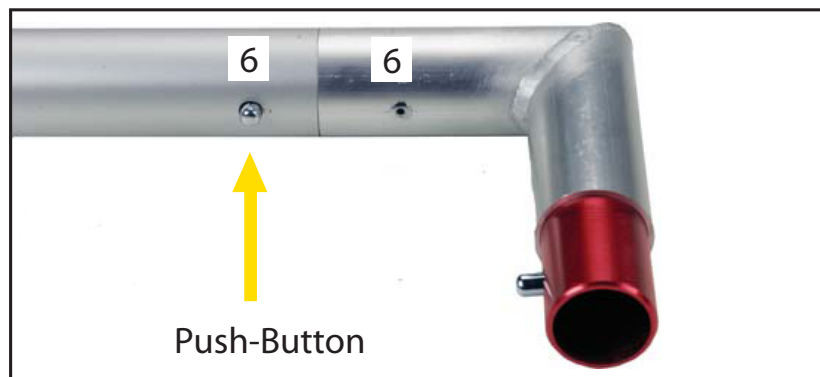

WHEN DISASSEMBLING ALUMINUM EXTRUSION, TIGHTEN ALL SETSCREWS AND LOCKS TO PREVENT LOSS DURING SHIPPING

866.652.2100

Steps:
1) Connect iPad clamshells to backwall where indicated, as shown in detail.

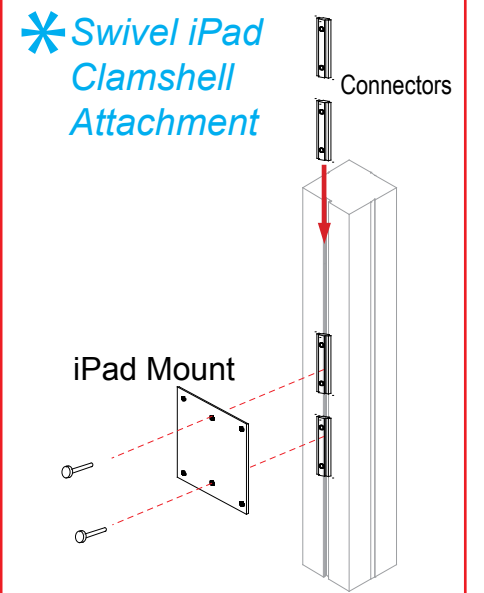
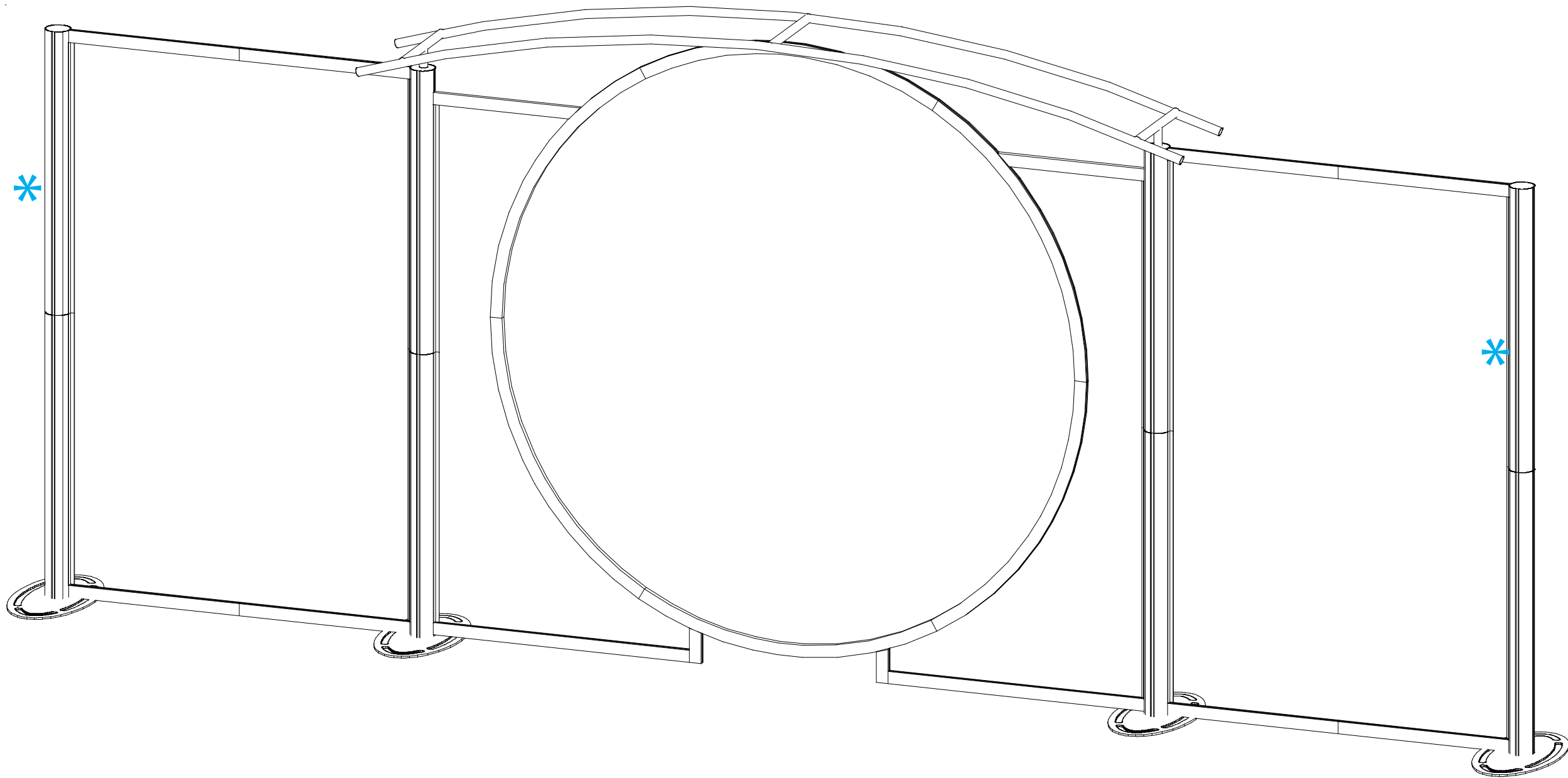

Slide connectors into groove of extrusion. Tighten setscrew to secure in place. Attach monitor mount to connectors with screws.

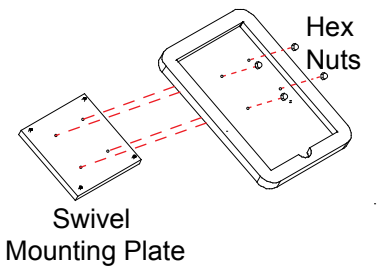

Bolt iPad clamshell to mounting plate with hex nuts.

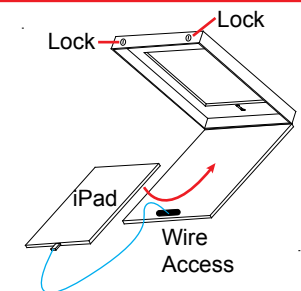

WHEN DISASSEMBLING ALUMINUM EXTRUSION, TIGHTEN ALL SETSCREWS AND LOCKS TO PREVENT LOSS DURING SHIPPING

866.652.2100

Item	Qty	Description
17	1	38" S40 Vertical Extrusion w/ Door Hinge
18	1	38" S40 Vertical Extrusion w/Door Stop
19	4	18" Z45 Horizontal Extrusion
20	2	20" Z45 Horizontal Extrusion

Steps:

- 1) Connect horizontals [19] to verticals [17,18] inserting infills as shown.
- 2) Connect horizontals [19] to extrusions on backside of front panel.
- 3) Connect horizontals [20] between verticals [17,18] as shown.
- 4) Hang door on hinges as shown in detail.
- 5) Attach shelf supports to Velcro on inside of assembled base.
- 6) Place internal shelf on shelf supports.
- 7) Place counter top on top of assembled base.

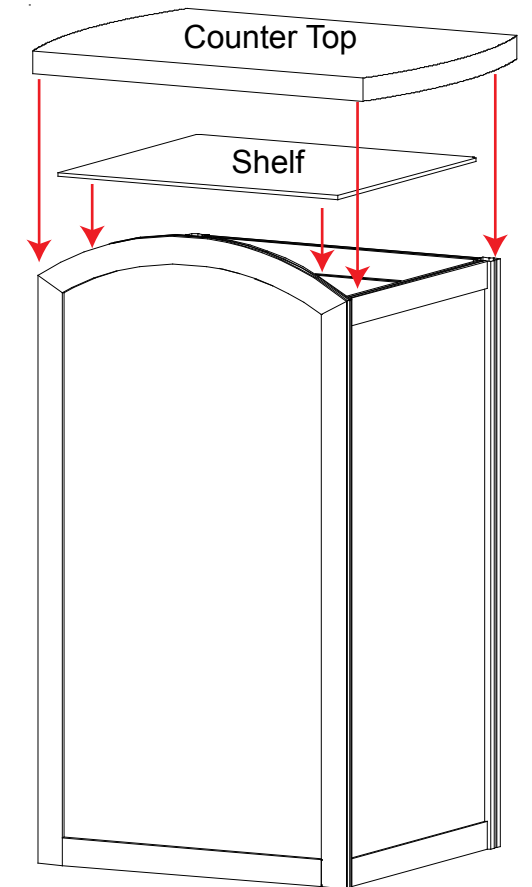
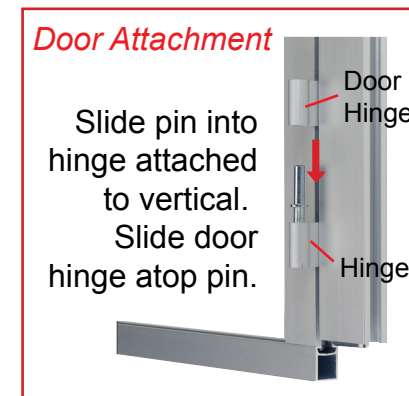
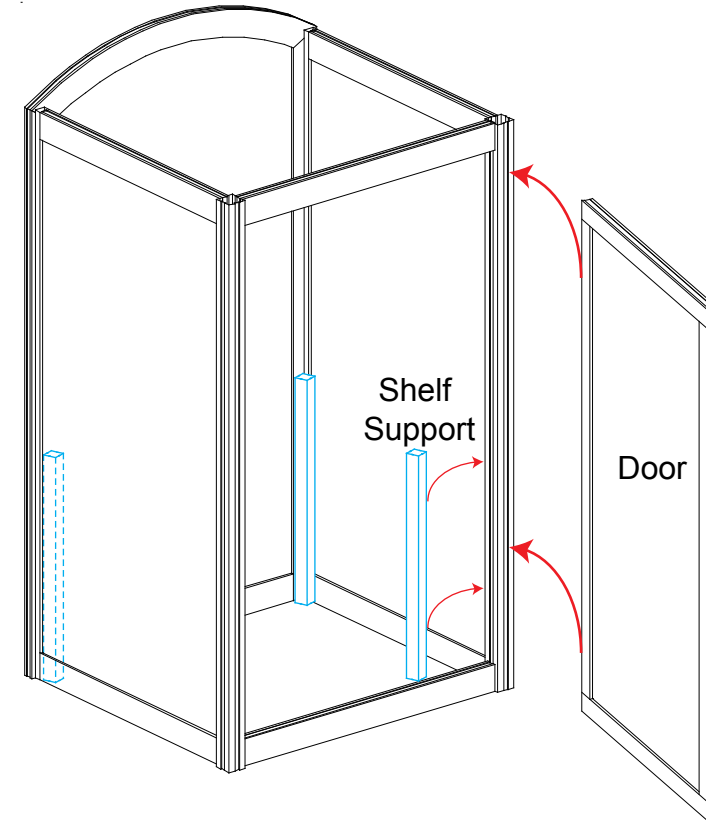
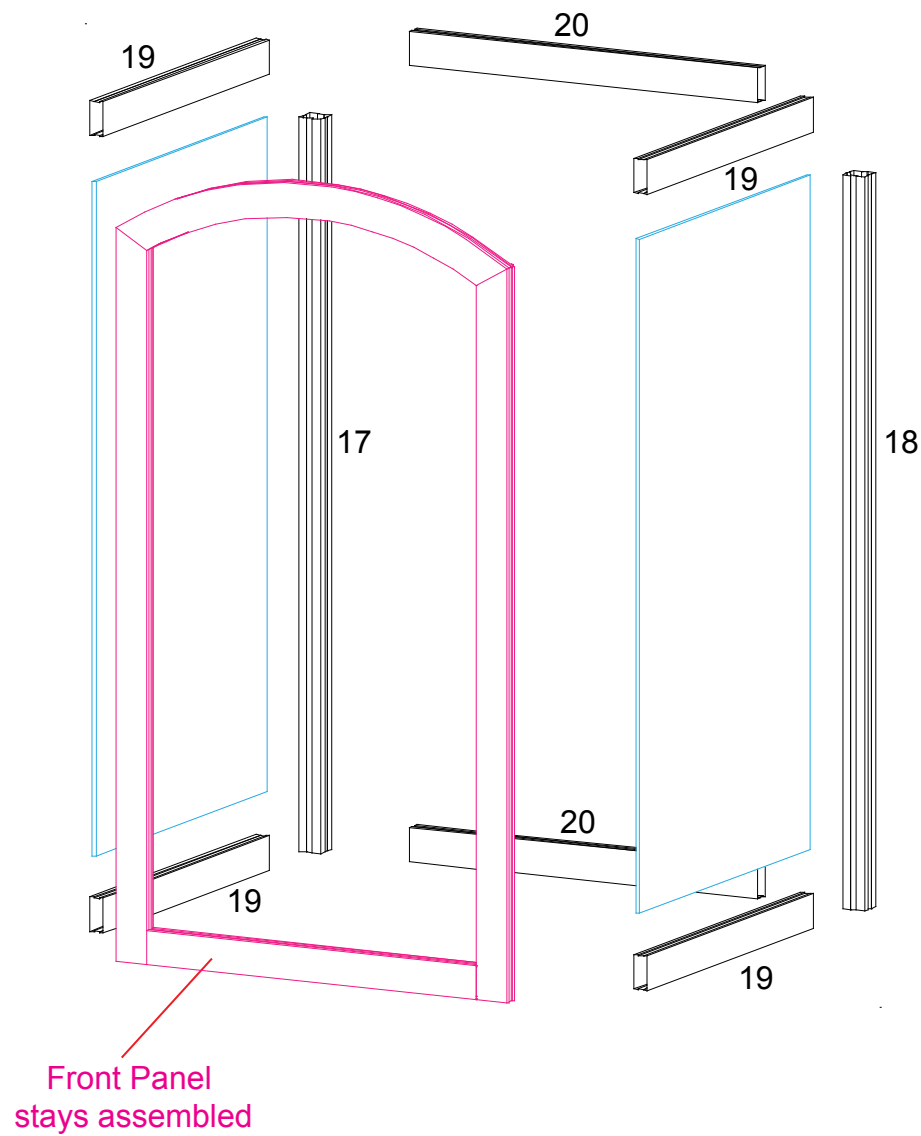
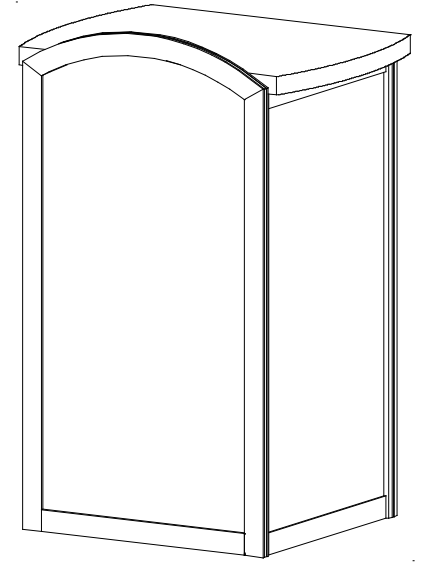

WHEN DISASSEMBLING ALUMINUM EXTRUSION, TIGHTEN ALL SETSCREWS AND LOCKS TO PREVENT LOSS DURING SHIPPING

866.652.2100

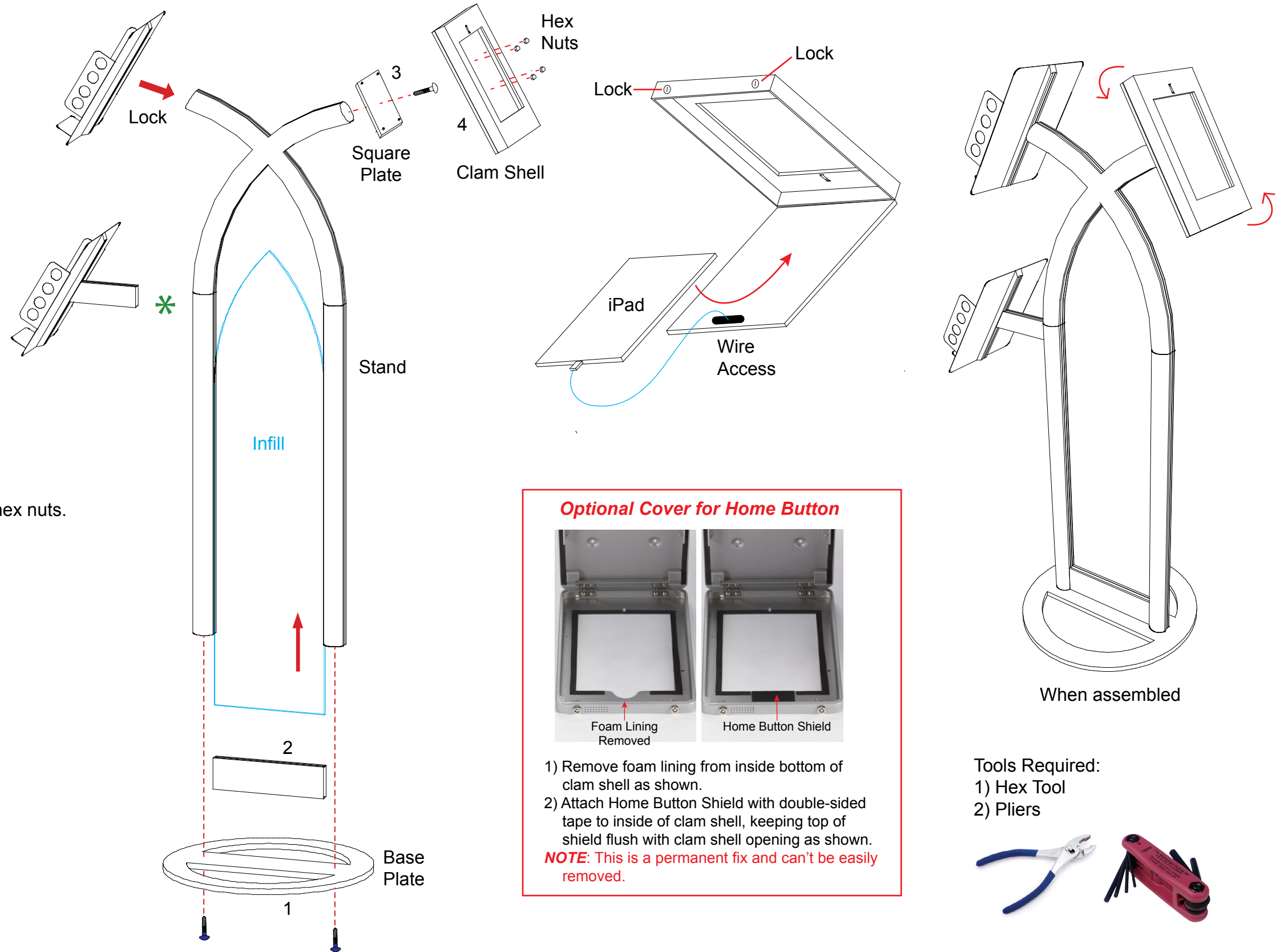

- Steps:
- 1) Slide infill between stand verticals as shown.
 - 2) Attach horizontal [2] between stand verticals.
 - 3) Attach base [1] to stand verticals using bolts.
 - 4) Attach square plate [3] to stand using bolt.
 - 5) Attach clam shell [4] to square plate [3] using hex nuts.
 - 6) Insert iPad and feed wire through hole.
 - 7) Attach pamphlet trays to stand. Refer to detail.

Adjustable Pamphlet Tray Attachment

Tighten Lock to Secure

Attach connector piece to tray as shown. Then connect assembled pamphlet tray to vertical extrusion.

Optional Cover for Home Button

Foam Lining Removed Home Button Shield

- 1) Remove foam lining from inside bottom of clam shell as shown.
- 2) Attach Home Button Shield with double-sided tape to inside of clam shell, keeping top of shield flush with clam shell opening as shown.

NOTE: This is a permanent fix and can't be easily removed.

- Tools Required:
- 1) Hex Tool
 - 2) Pliers



WHEN DISASSEMBLING ALUMINUM EXTRUSION, TIGHTEN ALL SETSCREWS AND LOCKS TO PREVENT LOSS DURING SHIPPING

Top View of Each Level

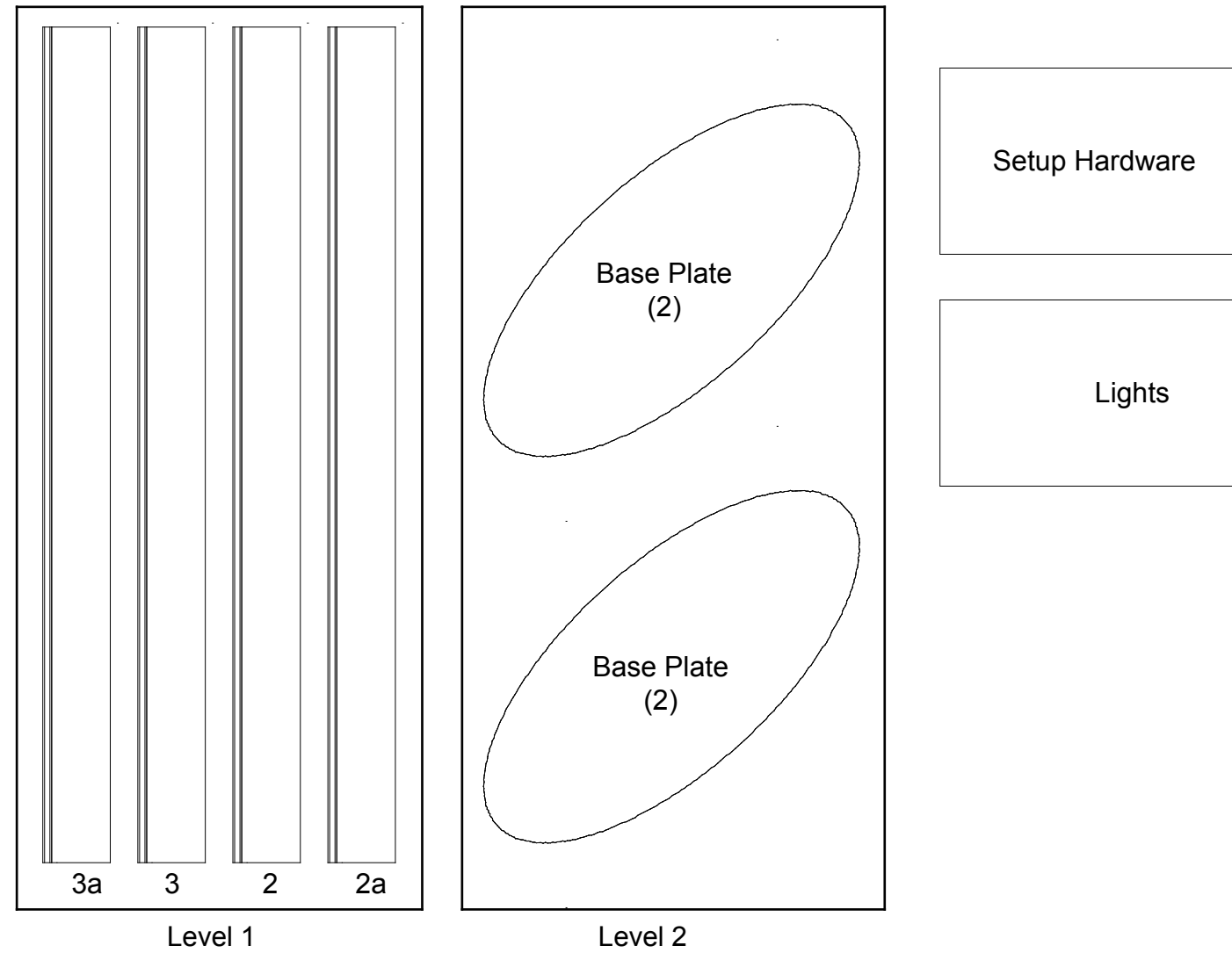

WHEN DISASSEMBLING ALUMINUM EXTRUSION, TIGHTEN ALL SETSCREWS AND LOCKS TO PREVENT LOSS DURING SHIPPING

Top View of Each Level

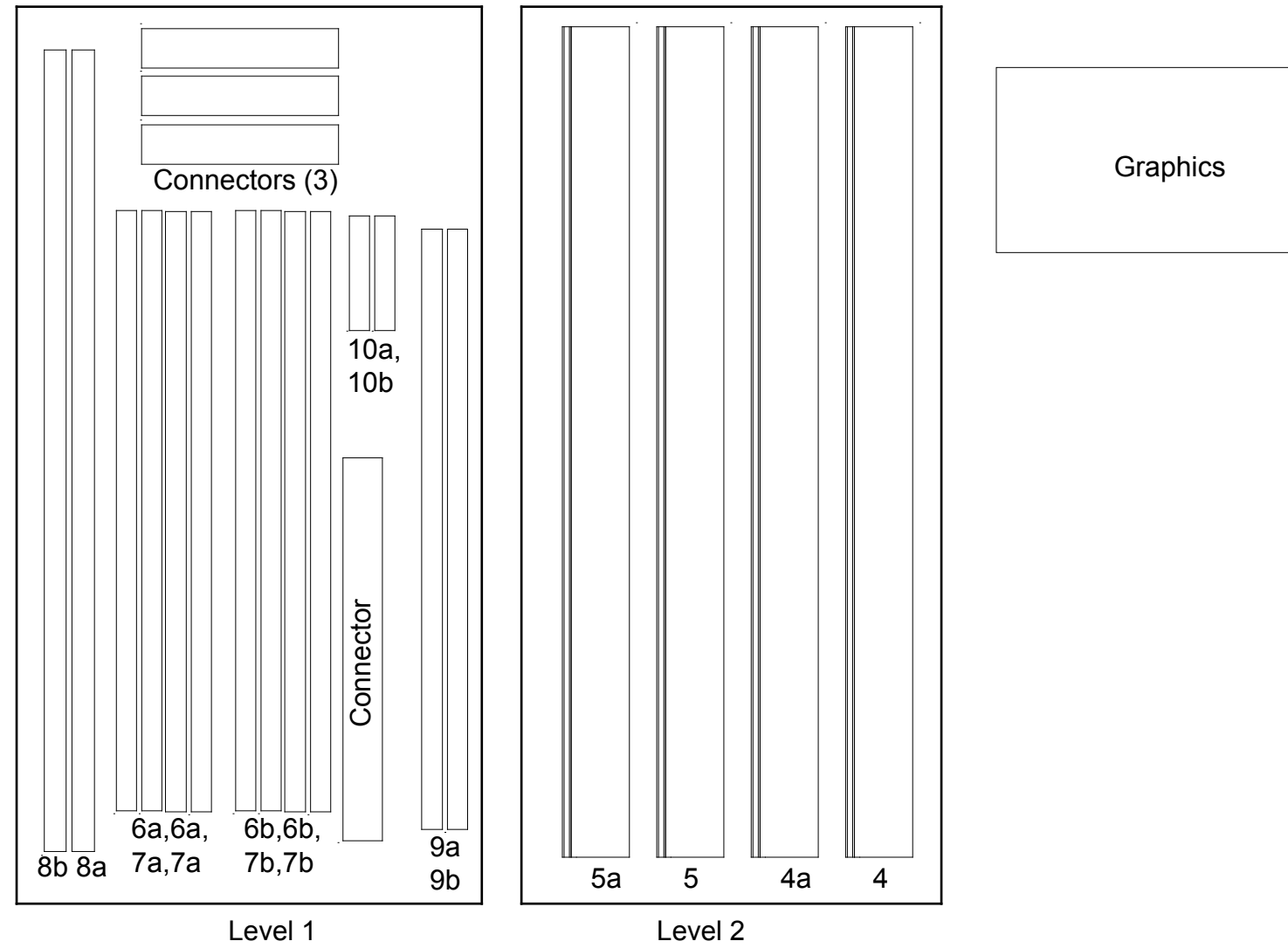

WHEN DISASSEMBLING ALUMINUM EXTRUSION, TIGHTEN ALL SETSCREWS AND LOCKS TO PREVENT LOSS DURING SHIPPING

Top View of Each Level

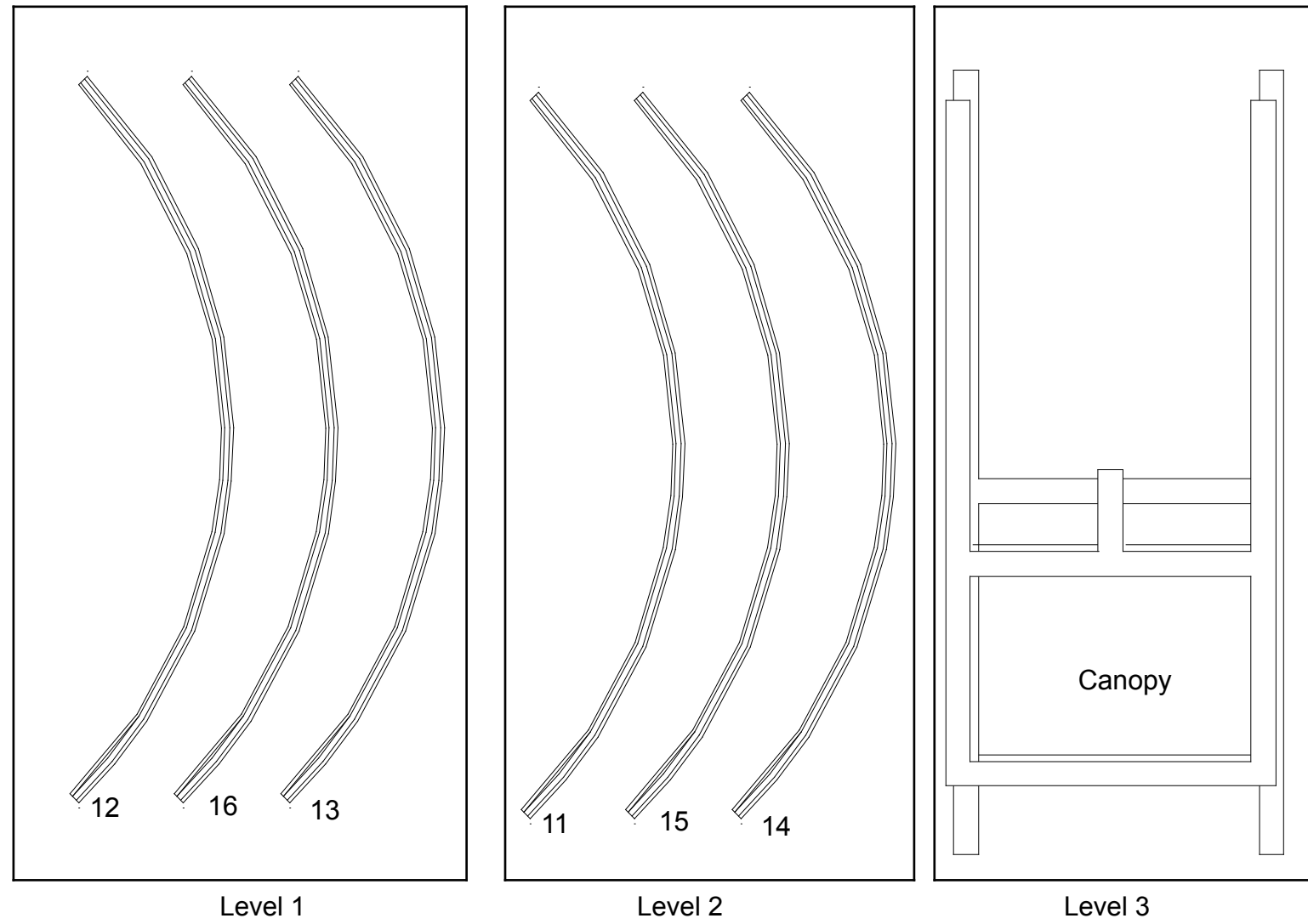

WHEN DISASSEMBLING ALUMINUM EXTRUSION, TIGHTEN ALL SETSCREWS AND LOCKS TO PREVENT LOSS DURING SHIPPING

Top View of Each Level

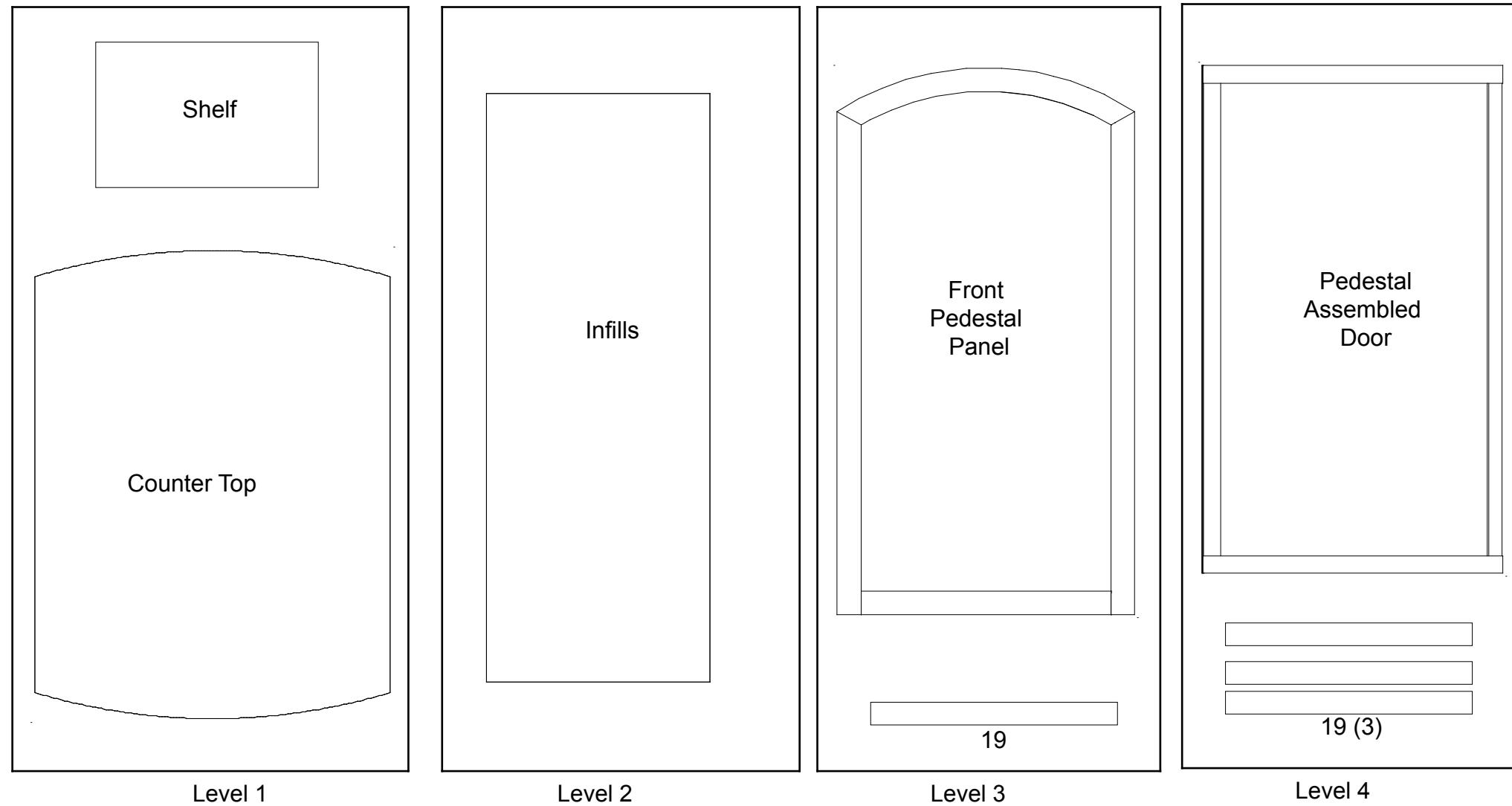

WHEN DISASSEMBLING ALUMINUM EXTRUSION, TIGHTEN ALL SETSCREWS AND LOCKS TO PREVENT LOSS DURING SHIPPING

Top View of Each Level

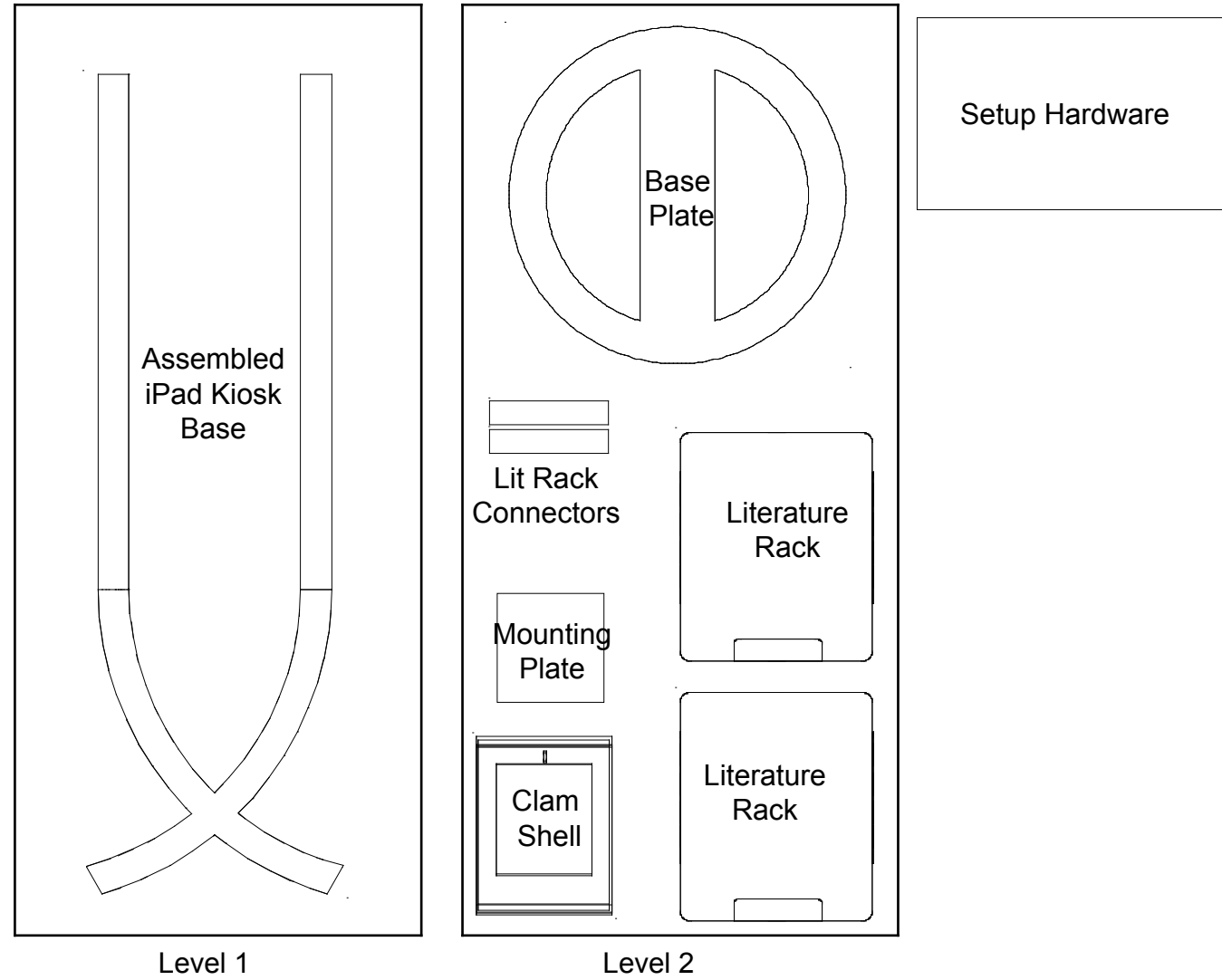

WHEN DISASSEMBLING ALUMINUM EXTRUSION, TIGHTEN ALL SETSCREWS AND LOCKS TO PREVENT LOSS DURING SHIPPING